

Micro inverter

NBQ800-EU/NBQ1000-EU/NBQ1200-EU

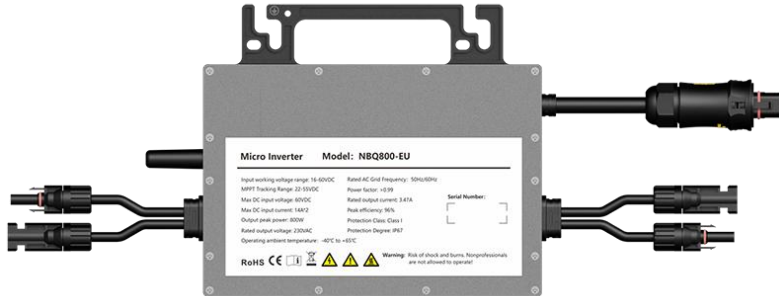

Connection:

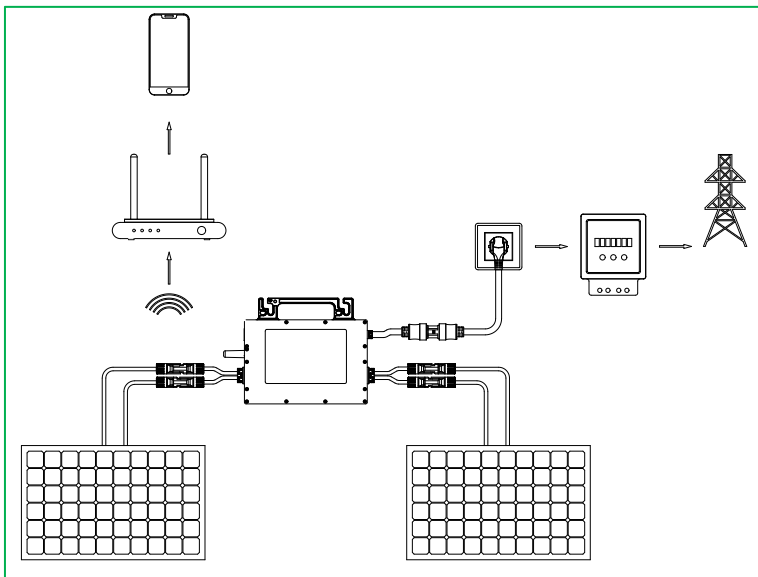

MModel	NBQ800-EU	NBQ1000-EU	NBQ1200-EU
Input parameters (DC)			
PV input power	425W×2	525W×2	625W×2
PV input connection	MC4 × 2		
Maximum input power	60V		
DC voltage input range	16-60V		
starting voltage	22V		
MPPT tracking range	22-55V		
MPPT tracking accuracy	>99.5%		
PV input current	14A*2	16A*2	18A*2
Output parameters (AC)			
Maximum output power	800W	1000W	1200W
rated output voltage	230V		
AC voltage range	190-270V		
maximum output current	3.47A	4.34A	5.21A
Rated output frequency	50Hz/60Hz		
harmonic distortion	<5%		
Output power factor	>0.99		
conversion efficiency	96%		
Protection level	Class I		
Defensive function			
Over/undervoltage/over/under frequency	有		
Overcurrent/overload/over temperature	有		
working condition			
ambient temperature	-40°C to +65°C		
LED/communication	LED/Wi-Fi / 2.4G		
Weight/Size	2.52Kg/227mm*195.5mm*42mm		
Compliantwith standards	VDE4105,EN62109-1,EN62321		